

F350-LED SERIES

SPECIFICATIONS

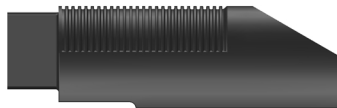

Housing

Made from heavy duty cast aluminum to withstand harsh weather.

Hardware

All exposed hardware is made of durable stainless steel, with industrial strength seals.

Interior Design & Optical

Energy efficient LED driver is mounted on a removable plate, with quick disconnect wiring to allow easy driver maintenance.
L70 at 50,000 hours with CRI≥70.

Exterior Design & Finish

Luminaire is designed to fit post top mounting or pendant mounting with our ornamental arms and poles, and is suitable for wet locations.
Finish is electrostatically applied with thermoset polyester powder-coat.

SIZES

	length	width	height	weight	tenon size	EPA
Large	22.5"	16"	8"	28 lbs	n/a	1.50 ft ²
Small	-	-	-	-	-	-

PHOTOMETRICS

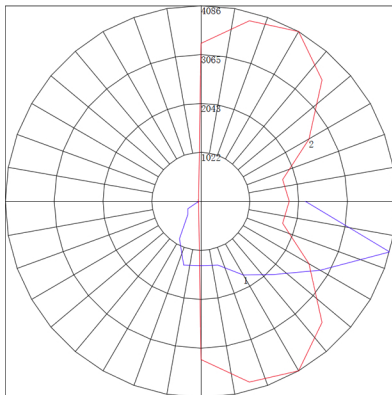

← polar graph

SAMPLE ILLUSTRATION
IES type IV, medium

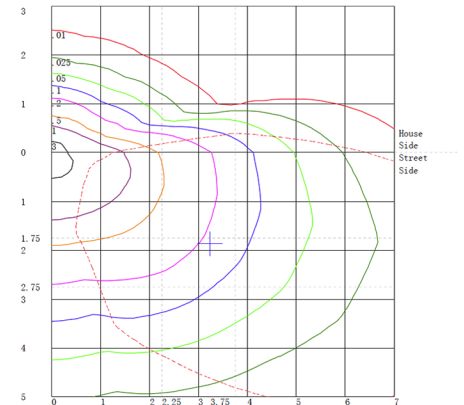

ISO footcandle →

PRODUCT	FITTER	DIFFUSER TYPE	WATTAGE	CCT	VOLTAGE	OPTICS	OPTIONS	FINIALS	COLOR
F350-L	N/A	CTG CLEAR TEMPERED GLASS	LED	3000K	120V~277V	IES TYPE II (2) III (3) IV (4) V (5)	DIM DIMMING CONTROL	N/A	STANDARD RAL 6005 GREEN 7012 GREY 8019 BRONZE 9011 BLACK 9016 WHITE *TEXTURE AVAILABLE CUSTOM RAL
			35W	4000K					
			50W	5000K					
			55W	6000K					
			70W	± 10% VARIANCE					
			80W						
			90W						
			120W						
			CUSTOM						
				347V					
				480V		PEC TWIST LOCK PHOTOCELL			

Product ordering sample

F350 - L - CTG - LED35W - 3000K - 120~277V - TYPE II - DIM - RAL9011 BLACK