

AREA LIGHTING: F220 (NAPLES)

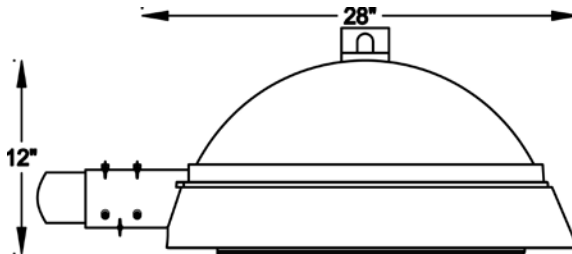

F220-L
 Weight: 21 lbs.
 EPA: 1.30 sq. ft.
 Size: 28" W x 12" H

Specification Features

- Ornamental heavy gauge cast aluminum base
- Quick disconnect ballast system mounted on removable plate
- Integrated button photocell optional
- Suitable for wet locations
- E39 mogul base or E26 medium base optional
- Powder coated finish

Product Ordering Number

SIZE	DIFFUSER TYPE	LIGHT SOURCE	VOLTAGE	OPTICS	OPTIONS	COLOR
F220-L	CTG Clear Tempered Glass	Up to 250 MH Option: pulse start ballast Up to 250 HPS 55, 85 or 165 Philips® QL ¹ CFL Fluorescent INC Incandescent LED Please contact HCI sales	QT (Quad tap 120, 208, 240, 277) TT (Tri tap 120, 277, 347) 120V Single 480 Single Please indicate voltage. If not specified factory will pre-wire at default 120v.	SR Segmented reflector IES type III or V	FUS Internal fusing PCB Luminaire integrated button type photocell	BLACK RAL 9011 GREEN RAL 6005 BRONZE RAL 8019 GREY RAL 7012 WHITE RAL 9016 CUSTOM

NOTES
¹QL is available in 120V or 240V for 55W and 85W systems.